

**American Pride - 526 Crest Road - Flat Rock, North Carolina 28731  
828-697-8827 Fax 828-697-7094**

### **Product Data Specifications**

Manhattan - Model #98OM36R(Recessed) or 980M36S(Surface Mount) Medicine Cabinet

<b>DOOR/MIRROR:</b>	11 15/16" x 35 15/16" x 1/8" Flat Mirror with Single Pass Polished edges and a high impact polystyrene door backing bonded to mirror with double faced tape and specially formulated bonding agent.	
<b>OVERALL SIZE:</b>	12" x 36" x 3-7/8"	<b>STORAGE DEPTH:</b> 3-3/8"
<b>ROUGH OPENING:</b>	10 1/4" x 34 1/4" x 2-1/2"	<b>PROJECTION FROM WALL:</b> 1-11/16"
<b>SHELVES:</b>	4 adjustable, injection molded polystyrene and 1 fixed white polystyrene	
<b>HINGE:</b>	3 Tri-brite galvanized split butt 2.5" hinges	
<b>DOOR OPERATION:</b>	Two riveted stainless steel striker plates and 2 magnetic catches	
<b>MOUNTING HARDWARE:</b>	4 #8 x 1 1/2"(Recessed) or #10 x 2-1/2"(Surface) Steel Tapping Screws	
<b>REVERSIBLE:</b>	Yes	
<b>DOOR BACKING:</b>	White High Impact Polystyrene	.060 Thickness
<b>CABINET:</b>	Injection Molded in White	Typical Wall Thickness .110
	Material: High Impact Polystyrene	All Color Non-Toxic

### **98 Series(Standard and 1A) Plastic(Polystyrene) Recessed or Surface Mounted Cabinet**

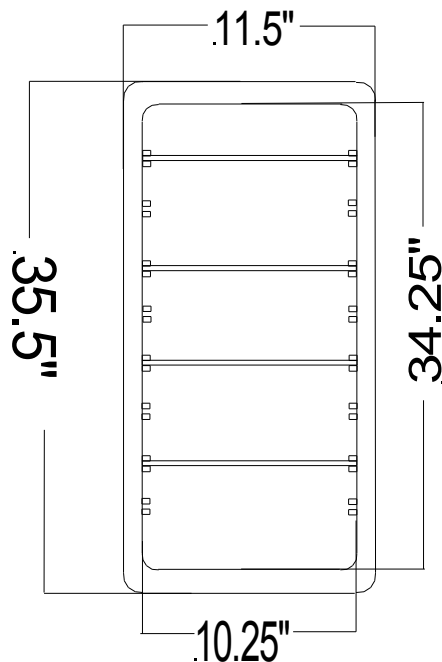

Storage Depth(3.375")  
Covers up 11.5" x 35.5"  
4 White Adjustable  
Polystyrene Shelves  
1 Fixed White Polystyrene shelf  
R.O.(10.25" x 34.25"x 2.5")